

POS	DESCRIPTION	MATERIALS	MATERIALS	MATERIALS	MATERIALS	MATERIALS	SPARES
1	Body	ASTM A105	ASTM A350 LF2	ASTM A182 F304	ASTM A182 F316	ASTM A182 F22 Cl.3	
2	Cover	ASTM A350 LF2	ASTM A350 LF2	ASTM A182 F316L	ASTM A182 F316L	ASTM A182 F22 Cl.3	
3	Plug	ASTM A350 LF2 or ASTM A182 F316L	ASTM A350 LF2 or ASTM A182 F316L	ASTM A182 F316L	ASTM A182 F316L	ASTM A182 F22 Cl.3	
4	Seat	AISI-420	AISI-420	AISI-420	AISI-420	AISI-420	X
5	Gasket Seat	AISI-304	AISI-304	AISI-304	AISI-304	AISI-304	X
6	Gasket Cover	F-Graphite W-316	F-Graphite W-316	F-Graphite W-316	F-Graphite W-316	F-Graphite W-316	X
7	Gasket Plug	SPW: F-Graphite W-316	SPW: F-Graphite W-316	SPW: F-Graphite W-316	SPW: F-Graphite W-316	SPW: F-Graphite W-316	X
8	Membrane valve	INOX	INOX	INOX	INOX	INOX	X
9	Plate valve	Stainless steel	Stainless steel	Stainless steel	Stainless steel	Stainless steel	X
10	Screen	AISI-316	AISI-316	AISI-316	AISI-316	AISI-316	X

Note 1: Other Materials and Dimensions on Request

Note 2: STANDAR CAPSULE (10°C) sub-cooling

Note 3: CAPSULE OPTIONS : (5°C – 30°C – 40°C) sub-cooling

Nota 4: Material A182 F316L is dual grade A182 F316/316L

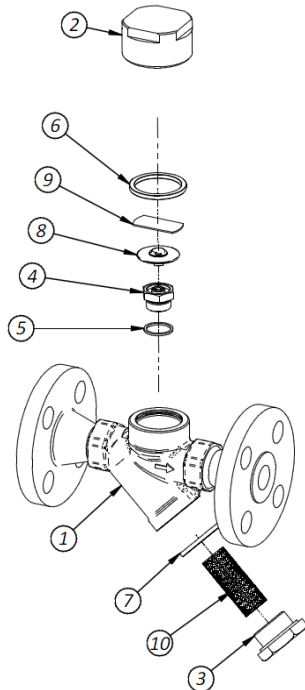

HOW TO INSTALL:

This steam trap can work in any position, however it should be preferably installed in horizontal line.

HOW TO DO MAINTENANCE:

1. Before starting, wear the required safety equipment and follow all plant safety procedures.
2. Stop the main line to make sure that no residues of dangerous waste fluid could be emitted.
3. Unscrew the cover(2).
4. Remove: plate valve(9), membrane valve(8), gasket cover(6), seat(4) and gasket seat(5).
5. Clean inside the body.
6. Replace: seat(4), gasket seat(5) and gasket cover(6)
7. Screw the cover (2).
8. Slowly start the plant and check if there are any line losses.
9. Apply a label to the trap with the maintenance date.

HOW TO SERVICE THE STRAINER:

1. Remove the plug(3)
2. Clean or change the screen(10).
3. Change the gasket(7) and rescrew the plug(3).

ORDER CODE

i.e. TSC22 3/4" 150RF A105
TSC22 1" BW-XS A350 LF2